



**ROAD TRAFFIC REGULATION ACT 1984 - SECTIONS 64 AND 65  
AUTHORISATION OF TRAFFIC SIGNS AND SPECIAL DIRECTIONS**

The Secretary of State for Transport, in exercise of his powers under Sections 64 and 65 of the Road Traffic Regulation Act 1984, and of all other powers enabling him in that behalf, for the purpose of informing road users of the conditions of use of bus lanes, and areas of road that may be used only by buses and other specified classes of vehicular traffic, on roads for which Nottingham City Council is the highway authority, hereby:

1. authorises the erection at appropriate sites of a traffic sign (hereinafter referred to as "the authorised sign A") conforming as to size, colour and character with that shown on the attached drawing numbered GT46/10/118(Pt1)-5, save that the days of the week and times of operation may be varied, or the legend "At any time" may be substituted as appropriate; and
2. authorises the erection at appropriate sites of a traffic sign (hereinafter referred to as "the authorised sign B") conforming as to size, colour and character with that shown on the attached drawing numbered GT46/10/118(Pt1)-6, save that the days of the week and times of operation may be varied, or the legend "At any time" may be substituted as appropriate; and
3. authorises the erection at the site indicated schematically on the attached plan numbered GT46/10/118(Pt1)-7 of a traffic sign (hereinafter referred to as "the authorised sign C") conforming as to size, colour and character with that shown on the attached drawing numbered GT46/10/118(Pt1)-8, save that the legend "At any time" may be substituted with days of the week and times of operation as appropriate; and



9. directs that, notwithstanding the provisions of Direction 18 to the 2002 Directions, the road markings shown in diagrams 1048.4 and 1049 in Schedule 6 to the 2002 Regulations may be used with the authorised sign E; and
10. directs that, notwithstanding the provisions of Direction 20(1) of the 2002 Directions, the authorised plate shall be used in combination with a sign conforming to diagram 953 in Schedule 5 to the 2002 Regulations; and
11. directs that it is a condition of this authorisation that the authorised signs A, B, C, D, E and the authorised plate may be placed only to indicate the effect of a corresponding Traffic Regulation Order; and
12. directs, without prejudice to any statutory provision to the like effect, that it is a condition of this authorisation that the erection of the authorised signs A, B, C, D, E and the authorised plate, at the said sites shall continue to have effect only until such day as may be appointed by one month's notice given by the Secretary of State in writing to the traffic authority for the removal or alteration of the authorised signs A, B, C, D, E and the authorised plate, and on that day the said authorisation shall, without prejudice to the giving of any further authorisation or direction, cease to have effect.

The provisions of Regulations 12, 18, 19 and 24 of the 2002 Regulations shall apply to the authorised sign A and the authorised sign C in the same manner as they apply to the sign shown in diagram 958 in Schedule 5 to those Regulations.

The provisions of Regulations 12, 18, 19 and 24 of the 2002 Regulations shall apply to the authorised sign B and the authorised sign D in the same manner as they apply to the sign shown in diagram 959 in Schedule 5 to those Regulations.



4. authorises the erection at the site indicated schematically on the said plan of a traffic sign (hereinafter referred to as "the authorised sign D") conforming as to size, colour and character with that shown on the attached drawing numbered GT46/10/118(Pt1)-9, save that the legend "At any time" may be substituted with days of the week and times of operation as appropriate; and
5. authorises the erection at the site indicated schematically on the attached plan numbered GT46/10/118(Pt1)-11 of a traffic sign (hereinafter referred to as "the authorised sign E") conforming as to size, colour and character with that shown on the attached drawing numbered GT46/10/118(Pt1)-10; and
6. authorises the erection at appropriate sites of a traffic sign consisting of a plate (hereinafter referred to as "the authorised plate") conforming as to size, colour and character with that shown on the attached drawing numbered GT46/10/118(Pt1)-12; and
7. directs that, notwithstanding the provisions of Direction 18 of the Traffic Signs General Directions 2002 (Part II of SI 2002/3113, "the 2002 Directions"), the authorised sign A and the authorised sign C may be used with the road marking shown in diagram 1010 in Schedule 6 to the Traffic Signs Regulations 2002 (Part I of SI 2002/3113, "the 2002 Regulations"); and
8. directs that, notwithstanding the provisions of Direction 18 of the 2002 Directions, the authorised sign B and the authorised sign D may be used with the road markings shown in diagram 1048 and 1049 in Schedule 6 to the 2002 Regulations; and

Department for Transport

7 May 2009

Date

6T 46/10/118 (P.1) -S

No.



Wheelchair  
accessible  
taxi

Mon - Fri  
7.30 - 9.30 am  
4 - 6 pm

Scheme Ref.	959v taper (3)		
Sign Reference	959v	'x' - height	50.0
Letter colour	WHITE	SIGN FACE	
Background	BLUE	Width	825mm
Border	WHITE	Height	1515mm
Material	Class RA2	Area	1.25sq.m

Department for Transport

7 May 2009

Date

GT 46/10/118 (P+1) - 6

No.



Scheme Ref.	959v (6)	
Sign Reference	959v	'x'-height 50.0
Letter colour	WHITE	SIGN FACE
Background	BLUE	Width 825mm
Border	WHITE	Height 1135mm
Material	Class RA2	Area 0.94sq.m

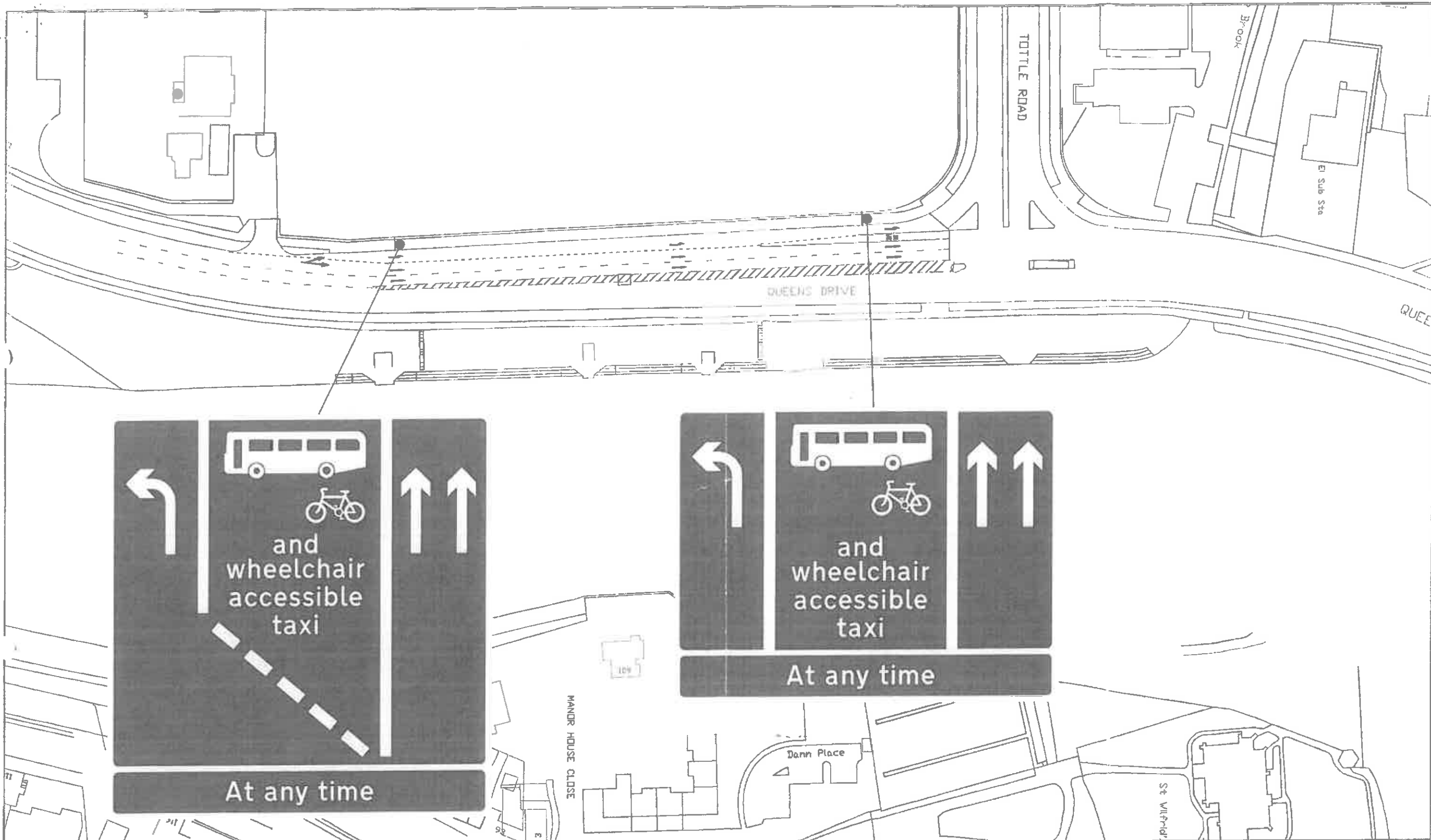

Department for Transport <b>7 Mar 2009</b> Date GT LG/10/118 (P+1)-7 No		<small>This map is reproduced from Ordnance Survey material with the permission of Ordnance Survey on behalf of the Controller of Her Majesty's Stationary Office. Crown copyright. Unauthorised reproduction infringes Crown copyright and may lead to prosecution or civil proceedings. Nottingham City Council 100018517 2808.</small>		 <b>Nottingham City Council</b> Environment & Regeneration Traffic, Safety & Parking Lawrence House Talbot Street Nottingham NG1 5NT Telephone: 0115 915 6077 Fax: 0115 915 6591		Scale 1:500 Drawn GN / HR Date 22/1/09		Scheme <b>Queens Drive, Nottingham Option 2</b> Title <b>Bus Lane Signing - Request for Authorisation</b>			
Rev.	Date	Details	Ch'd	CAD	Checked	Authorised	Drawing Number	Revision			
							TM/08/9815/1183				

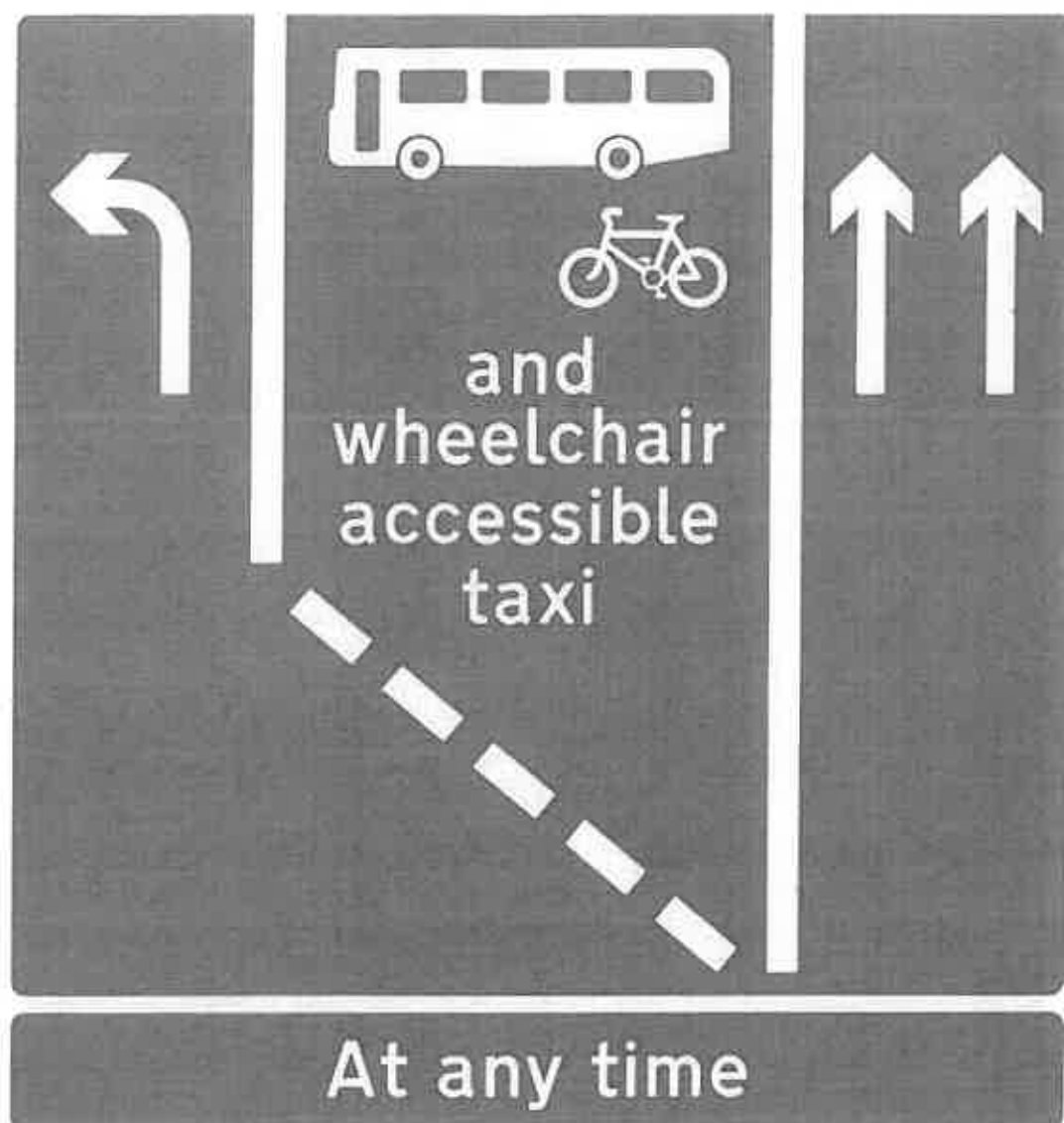

Scheme Ref.	Queens Drive taper option 2		
Sign Reference	960v	'x'-height	75.0
Letter colour	WHITE	SIGN FACE	
Background	BLUE	Width	2045mm
Border	WHITE	Height	2155mm
Material	Class RA2	Area	4.40sq.m

Department of Transport
7 May 2009
Date
GT 46/10/118 (P1)-8
No.



Scheme Ref.	Queens Drive option 2		
Sign Reference	960v	'x'—height	75.0
Letter colour	WHITE	SIGN FACE	
Background	BLUE	Width	2045mm
Border	WHITE	Height	1570mm
Material	Class RA2	Area	3.21sq.m

Department for Transport
7 May 2009
Date
GT 46/10/118 (P1)-9
No.





Scheme Ref.	Bobbers Mill Bridge		
Sign Reference	2114 v	'x' - height	75.0
Letter colour	BLACK	SIGN FACE	
Background	WHITE	Width	1425mm
Border	BLACK	Height	985mm
Material	Class RA2	Area	1.40sq.m

7 May 2009  
 GT 46/10/118 (P1) 10



**and  
wheelchair  
accessible  
taxi only**

Scheme Ref.	Supplementary plate		
Sign Reference	953.2v	'x'—height	50.0
Letter colour	BLACK	SIGN FACE	
Background	WHITE	Width	620mm
Border	BLACK	Height	490mm
Material	Class RA2	Area	0.30sq.m

Department for Transport
7 May 2009
Date
GT 46/10/118(P+1)-12
No.